

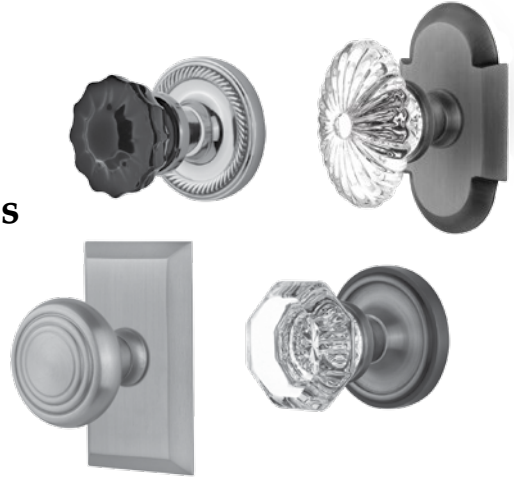

# Pre-Attached Knob Installation Instructions For Rosettes and Short Plates

## Passage and Privacy

*With step-by-step Installation Pictograms  
and Drilling Template*



**Tools Required: # 2 Phillips Screwdriver (Not power tools)**

### Door Handing - Rosettes and Short Plates

Door handing is critical for Split-Finish, or Split-Design products. It's also used to determine where the Interior and Exterior halves of the lockset are located on the door. And, it's used to position the latch tongue in relation to the strike plate.

**Inside of Door** - The **Inside** of a door refers to the side of the door that faces the room. For example, for a bedroom door on a hallway, the **Inside** of the door would face the bedroom.

**Outside of Door** - The **Outside** of a door refers to the side of the door that faces away from the room. The **Outside** of a door is generally more visible to visitors, and therefore a rosette on this side of the door has no visible screws. For example, on a bedroom door, the **Outside** would face the hallway.

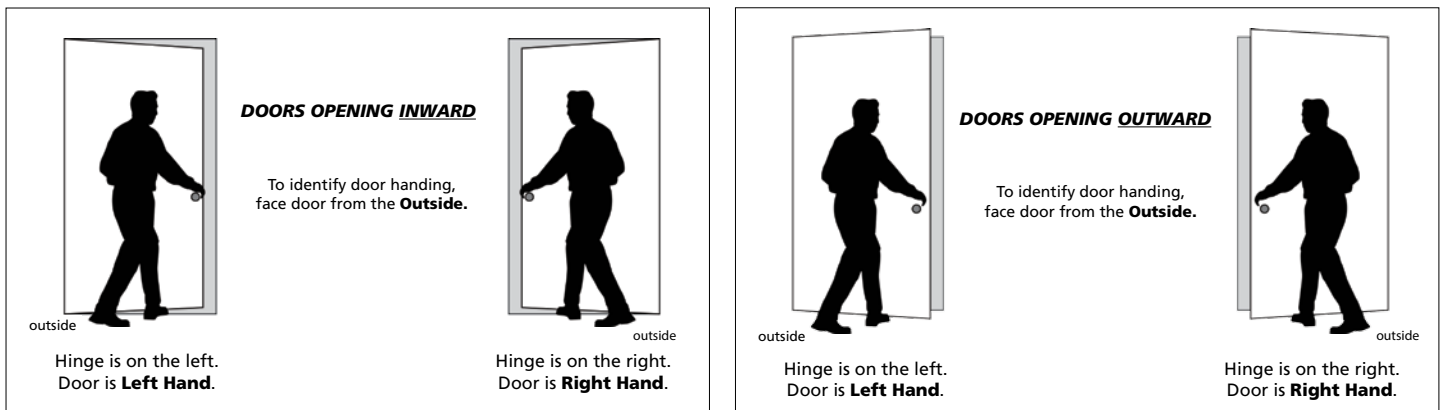

### INSTALLATION RULES:

- 1) Lockset machine mounting screws are inserted from the inside.
- 2) Privacy pin holes are next to the door side containing the latch.
- 3) Latch tongues have a beveled side, and this side should contact the curved end of the face plate, and curved end of the strike plate.  
(See \*Latch Tongue Note on page 2.)



For assistance call 1-800-522-7336 Mon-Fri, 7 am to 5 pm Mountain Time

# Rosette and Shortplate Door Hardware Installation Instructions

## PRE-ATTACHED KNOBS

## Passage/Privacy

Note: Passages and Privacies fit doors 1-3/8" to 1-3/4" thick.

Tools Required: #2 Phillips Screwdriver (Not power tools)

### A

#### Backset Information

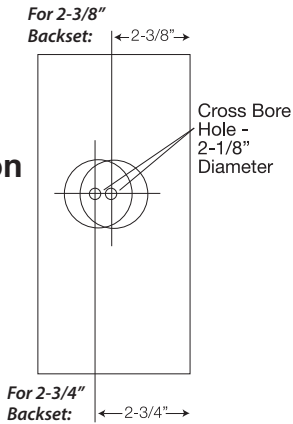

#### NOTE:

DRILLING  
TEMPLATES  
ON  
SEPARATE  
INCLUDED  
SHEET

### B

#### Install Latch

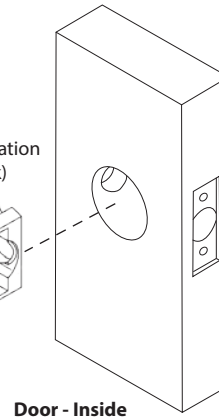
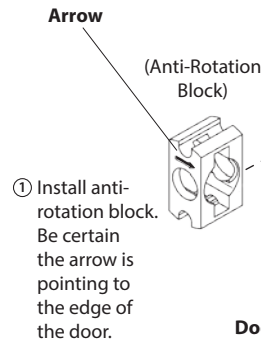

- Install latch and rotate the latch tongue \* to change handing. (See page 1 for handing)
- Install faceplate with 1" screws.

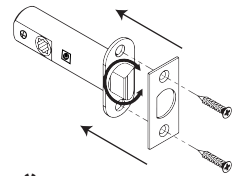

#### \* Latch Tongue Note

Bevel side of latch tongue should contact curved end of face plate, and curved end of strike plate.

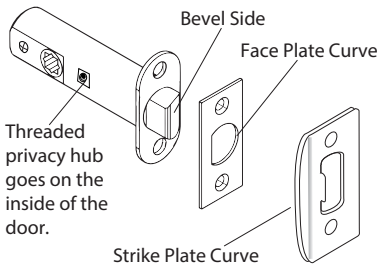

### C

#### Insert Spindle

- Push spindle button down and hold during insertion
- Insert

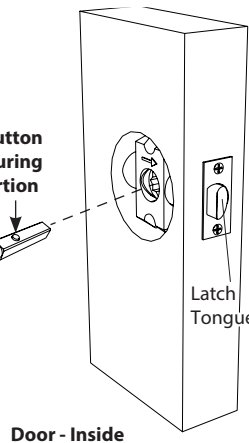

### D

#### Install Exterior Half of Lockset



### E

#### Install Interior Half of Lockset

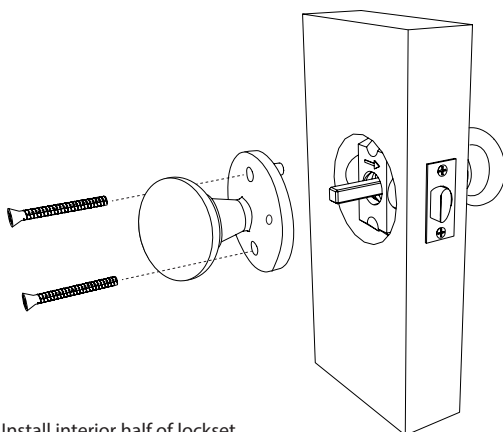

Install interior half of lockset with 1-1/2" machine screws (1-3/8" thick doors), or 1-3/4" machine screws (1-3/4" thick doors)

### F

#### Install Privacy Pin

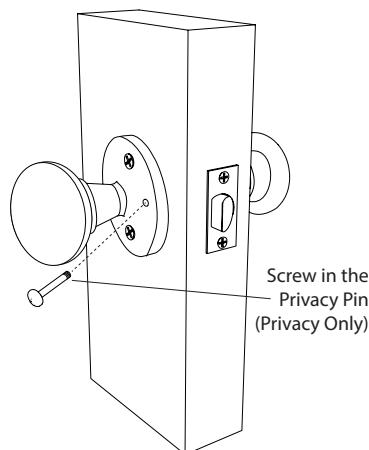

### G

#### Install Strike Plate

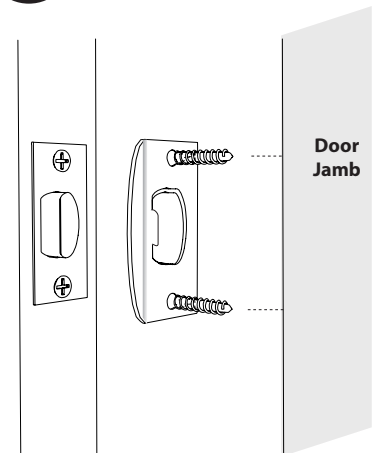

Attach the strike plate to the door jamb using 1" long wood screws.

# Exploded Diagram

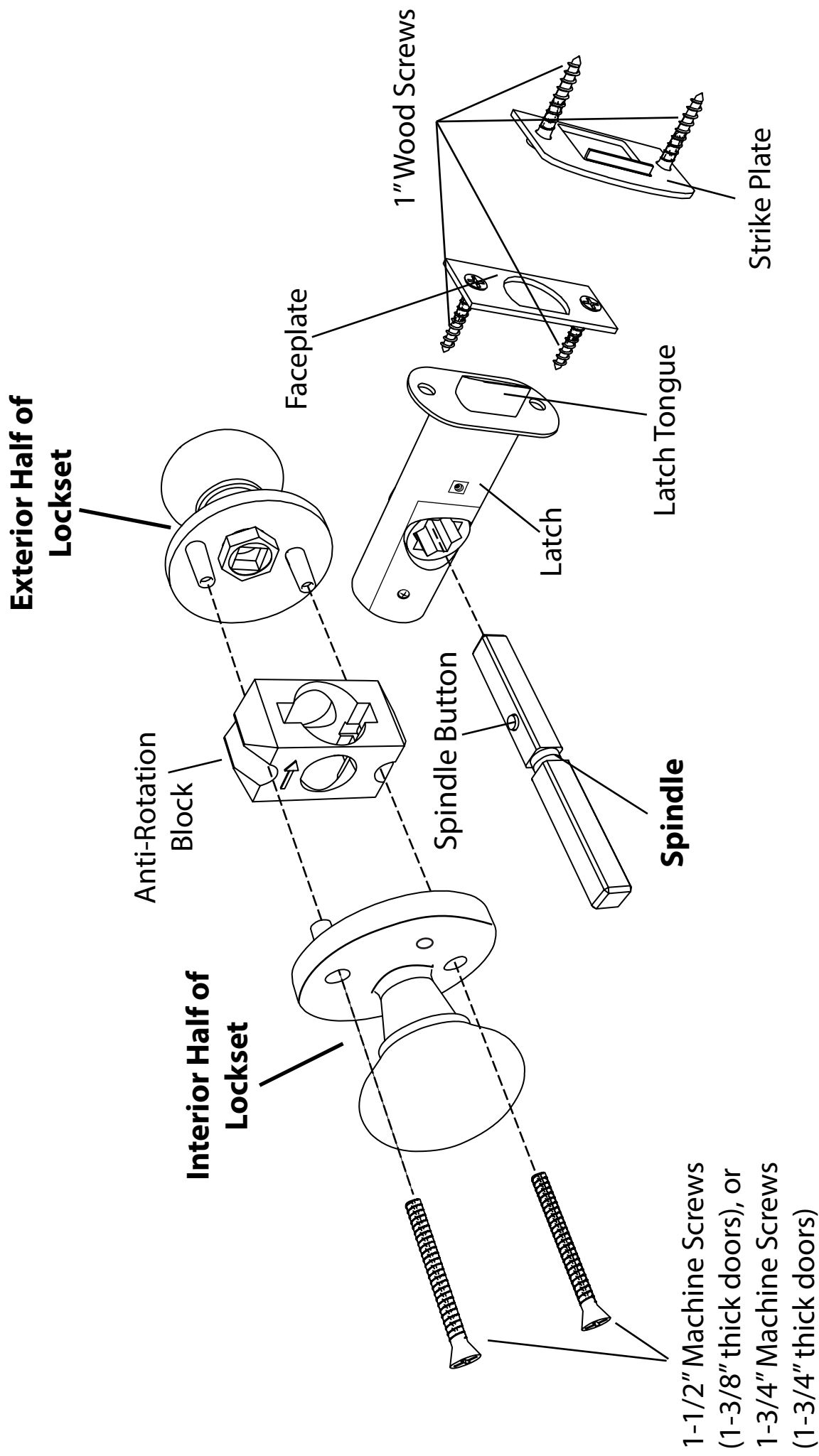

# DUMMY INSTALLATION AND DOOR PREPARATION TEMPLATE

(2) FOLD TEMPLATE ALONG DOTTED LINE, AND POSITION FOLD ON THE EDGE OF THE DOOR. TAPE TEMPLATE TO FACE OF DOOR.

FOLD ALONG DOTTED LINE - EDGE OF DOOR

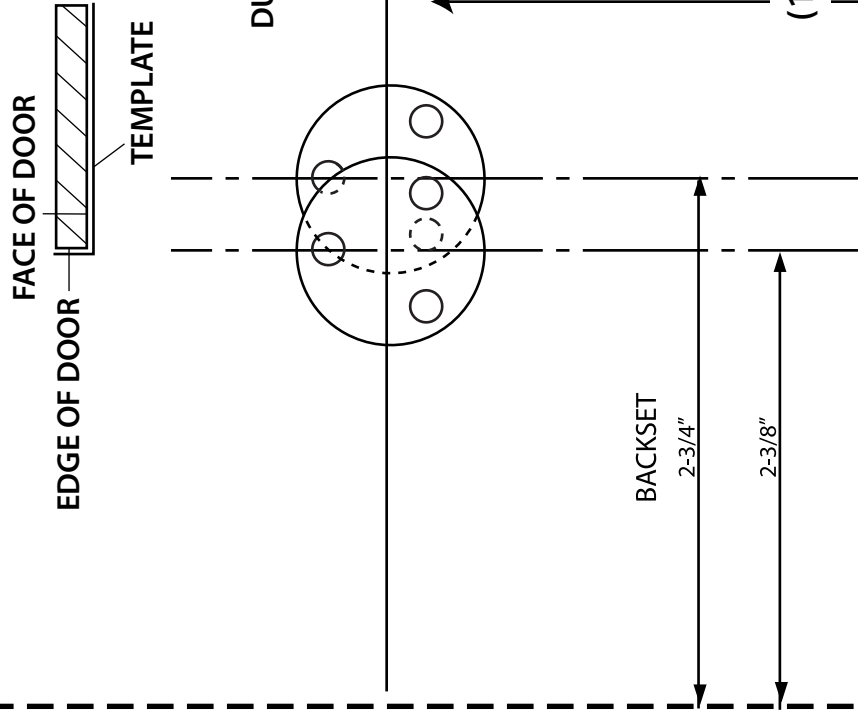

(3) BEFORE DRILLING VERIFY THE BACKSET OF YOUR EXISTING DOORS IN YOUR HOUSE. DRILL PILOT HOLES USING A 7/64" DIAMETER BIT.

(4) INSERT THREE WOOD SCREWS, SLIDE ROSETTE OVER MOUNT, AND SCREW-ON KNOB.

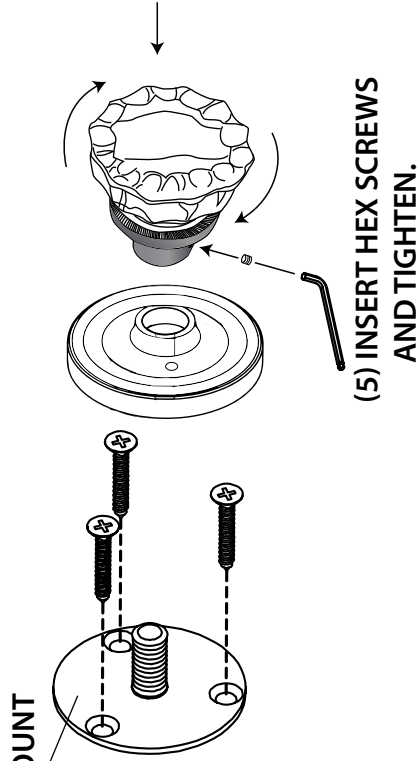

(1) MEASURE FROM THE FLOOR TO THE CENTER OF EXISTING LOCKS, AND USE THIS DISTANCE AS THE CENTER OF THE DUMMY MOUNT. IF THERE ARE NO EXISTING LOCKS, POSITION THE DUMMY MOUNT 36" TO 38" FROM THE FLOOR.

FLOOR